

WARNING: Danger of Scalding!



Recognized mark of the steam release



THANE *HOUSEWARES*TM



USER'S GUIDE

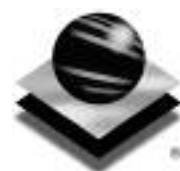

Thane International, Inc.
La Quinta, CA 92253
www.thane.com

Distributed by:
Thane Direct Canada
Toronto, Canada
www.thane.ca

Thane Direct UK Ltd.
Admail ADM3996, London, W1T 1ZU
www.thanedirect.co.uk

Copyright © 2008 Thane International, Inc.
Thane Housewares is a division of Thane International, Inc.
MADE IN CHINA

H2O MOP Ultra-DONLIM-Eng. (May 11, 2009)

THANE *HOUSEWARES*TM



USER'S GUIDE



**H2O Mop[®] Ultra[™] +
Hand-Held Portable
Steamer +
Carpet Cleaner**

MODEL:
EP2120

IMPORTANT SAFETY INFORMATION
READ ALL INSTRUCTIONS BEFORE USING STEAM CLEANER.
USE ONLY AS DIRECTED.



THANK YOU

Congratulations for choosing the H2O Mop® Ultra™, a new and improved steam cleaner with a detachable hand-held steamer. The H2O Mop® Ultra™ is a new way of cleaning that is effective and far more hygienic than conventional methods. The H2O Mop® Ultra™ achieves a high degree of hygiene and increases cleansing power by converting water to steam using a microfiber floor cloth to enhance absorbency. When contact is made with floor surfaces, dirt and grime can be eliminated in a matter of seconds. Since the H2O Mop® Ultra™ uses the active power of steam without the use of detergents or soap, it is environmentally friendly.

Regular steam cleaning also helps destroy dust mites, some types of bacteria, fungus and mildew. To disinfect a specific area, position the steamer over the area for a minimum of 10 seconds.

The steam temperature will reach approximately 90-100°C (194-212°F). Use this procedure to disinfect floors in bathrooms, showers, around kitchen counters, pet sleeping quarters, etc.



TROUBLESHOOTING GUIDE

Problem	Possible Cause	Solution
THE UNIT DOES NOT POWER ON	The unit is not plugged in	Make sure the unit is plugged into a proper outlet and the switch is ON
REDUCED STEAM OR NO STEAM	Water Tank Empty	Fill Water Tank (Part 9)
	Blocked Steam Nozzle	Remove Mop Head (Part 16) and Clean the Nozzle.
	Water filter blocked	Check the water filter. If it is getting dirty, replace with a new water filter.
	The copper ball in Water Tank (Part 9) does not sink into water	Wobble your mop by the handle and make sure the copper ball in Water Tank (Part 9) is in water
STEAM ESCAPES FROM CONNECTIONS	Limescale Deposit	Follow cleaning procedure to remove limescale in this User's Guide
	Attachment is not connected properly	Turn the unit OFF, allow it to cool down, disconnect the accessories and reattach them.
WATER IS DRIPPING FROM THE EXTENSION HOSE ATTACHMENT (optional item)	Debris or obstructions at the connection points	Remove the accessory and check and clean connection points
	There is condensation inside the hose	Hold the hose vertically and allow any water to drain out.
THE CLEANING CLOTH BECOMES WET	The cloth gets saturated with water	Remove wet cloth and replace with a dry cleaning cloth or allow cloth to cool, then wring out and reattach.



WARNING:
TO REDUCE THE RISK OF FIRE, ELECTRIC SHOCK OR INJURY, UNPLUG APPLIANCE FROM OUTLET BEFORE SERVICING.



WATER FILTER REPLACEMENT

! IMPORTANT:

It is required to replace the water filter every three to six months or after approximately 50 to 75 hours of use.

Water Filter removes minerals and other impurities from tap water. It prevents water deposits from damaging your H2O Mop® Ultra™. To maximize performance of filter, distilled water may be used.

HOW TO REPLACE THE WATER FILTER:

How To Release the Hand-Held Steamer Unit (as illustrated on page 8 - How to use the Hand-Held Steamer)

- 1) Release the Hand-Held Steamer Body Lock (Part 7) by lifting up
- 2) Push the Hand-Held Steamer Release button (Part 6) upward
- 3) Take Hand-held Steamer out by lifting upward and pulling backward.

How To Remove Water Tank

- 4) Press the Water Tank Release button and Pull Water Tank out.
- 5) Remove Water Filter by pulling it out and lifting up.

How To Remove Water Filter

6) Pull the water filter out carefully but firmly as illustrated in Fig. 1 until you release the tongue (located on the top part of the water filter) from the designated slot as illustrated in Fig. 2. You will here a click sound.

7) Lift the water filter up to release the water filter nozzle from the designated hole, as illustrated in Fig. 3.

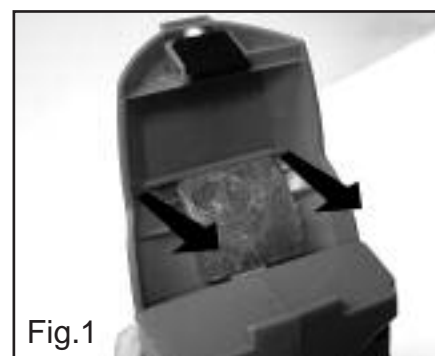

Fig.1



Fig.2

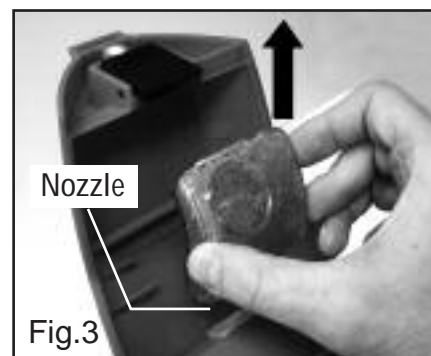

Fig.3

8) To install the new water filter, place the nozzle located at the bottom of the filter in the designated hole and gently push down. Push the top of the filter down to ensure the tongue slides into the designated slot and locks in place.

NOTE: To maintain optimum performance you must rinse out the water tank on a weekly basis while in use. Always ensure that the appliance is switched OFF and unplugged before cleaning. Wait a few minutes for it to cool down before cleaning. Wipe with a damp cloth and allow to dry thoroughly before reusing or storing.



IMPORTANT SAFEGUARDS

PLEASE READ CAREFULLY

**FAILURE TO FOLLOW THE PRODUCT INSTRUCTION WILL VOID YOUR WARRANTY
READ ALL INSTRUCTIONS BEFORE USING THIS STEAM CLEANER**

When using an electric appliance, basic precautions should always be followed, including the following:

⚠ WARNING – DANGER OF SCALDING, TO REDUCE THE RISK OF FIRE, ELECTRIC SHOCK, OR INJURY:

1. Verify that the main voltage indicated on the product corresponds with the voltage of your electrical outlet.
2. To provide continued protection against risk of electric shock, connect to properly grounded outlets only.
3. This product is designed for domestic use only.
4. Do not use outdoors.
5. Do not leave the H2O Mop® Ultra™ unattended while plugged in. Unplug the electrical cord when not in use and before servicing.
6. Do not allow to be used as a toy. Close attention is necessary when used near children, pets or plants.
7. This appliance is not intended for use by persons (including children) with reduced physical, sensory or mental capabilities, or lack of experience and knowledge, unless they are under supervision or had instruction concerning use of the appliance by a person responsible for their safety.
8. Young children should be supervised to ensure that they do not play with the appliance.
9. Never direct steam towards people, animals or plants.
10. Do not immerse the H2O Mop® Ultra™ into water or other liquids.
11. Do not use with damaged cord or plug. If the H2O Mop® Ultra™ is not working as it should, has been dropped, damaged, left outdoors, or immersed in water, return it to the distributor. If the supply cord is damaged, it must be replaced by the manufacturer or a similarly qualified person to avoid hazard.
12. Do not pull or carry by the cord, use the cord as a handle, close a door on the cord, or pull the cord around sharp edges or corners. Keep the cord away from heated surfaces.
13. Never force the plug into an outlet.
14. Do not use extension cords or outlets with inadequate current carrying capacity.
15. Unplug after each use. To safely unplug, grasp the plug and gently pull, do not unplug by pulling on the cord.
16. Do not handle plug or H2O Mop® Ultra™ with wet hands or operate without shoes.
17. Do not insert any objects into openings. Do not use with any opening blocked.
18. Do not use without floor cloth in place.
19. Do not use without water in the water tank.
20. When using on stairs use extra caution.
21. Store your H2O Mop® Ultra™ indoors in a cool, dry area.
22. Keep your work area well lit.
23. Never put hot water or any other liquids such as aromatic, alcoholic, or detergent products into the H2O Mop® Ultra™ water tank. This will make the operation unsafe and damage the unit.
24. Always keep the output for the steam clear. Avoid placing the steam opening on soft surfaces which may block the flow of steam. Keep the openings free from lint, hair and other potential obstructions to ensure proper flow.



IMPORTANT SAFEGUARDS CONTINUED

25. Use only as directed in this manual. Use only manufacturer's recommended accessories. Use of attachments not provided or sold by the manufacturer or authorized resellers may cause fire, electric shock or injury.
26. The liquid or steam should not be directed towards equipment containing electrical components, such as the interior of ovens.
27. Do not expose to rain.
28. Do not handle steam cleaner with wet hands.
29. Do not use the H2O Mop® Ultra™ in enclosed spaces that are filled with flammable, explosive or toxic vapor such as paint thinner, oil-based paint or certain moth proofing substances.
30. Do not use on leather, wax polished furniture or floors, unsealed hardwood or unsealed parquet floors, synthetic fabrics, velvet or other delicate steam-sensitive materials.
31. Do not use for space heating purposes.
32. Unplug appliance from outlet before servicing
33. Do not touch hot surface. Use handles or knobs.
34. Do not let cord hang over edge of table or counter, or touch hot surfaces.
35. Do not place on or near a hot gas of electric burner, or in a heated oven.
36. Always attach plug to appliance first, then plug cord into the wall outlet. To disconnect, turn any control to "off", then remove plug from wall outlet.
37. Do not use appliance for other than intended use.
38. Care should be taken when using appliance due to emission of steam.



THIS MODEL IS FOR HOUSEHOLD USE ONLY.
Commercial use of this unit voids the manufacturer's warranty.

GROUNDING INSTRUCTIONS

WARNING: NOTE: These instructions apply to 120V unit only.

This appliance must be connected to a grounded wiring system. If it should malfunction or break down, grounding provides a safe path of least resistance for electrical current, reducing the risk of electrical shock. The cord for this appliance has an equipment-grounding conductor and a grounding plug. It must only be plugged into an outlet that is properly installed and grounded in accordance with all local codes and ordinances.

This appliance has a grounding attachment plug that looks like the plug in the drawing provided.

Improper connection of the equipment-grounding conductor can result in risk of electrical shock. Check with a qualified electrician or service person if you aren't sure if the outlet is properly grounded. **DO NOT MODIFY THE PLUG.**

If it will not fit the outlet, have a proper outlet installed by a qualified electrician. No plug adapter should be used with this appliance.

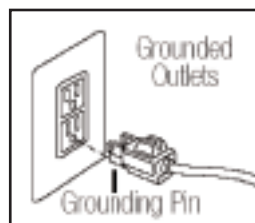

HOUSEHOLD USE ONLY

SAVE THESE INSTRUCTIONS



By using cleaning solution

1. Prepare a solution of 1/3 white vinegar and 2/3 tap water and add to the water tank.
2. Secure and position the mop head to ensure steam released is aimed away from the floor or surrounding objects and surfaces. Plug the unit in and wait for the green light. Turn the unit ON by pressing the ON/OFF switch and let the Mop produce steam until the vinegar/water solution is used up.
3. Repeat the above procedure as many times as necessary until a normal steam flow rate is achieved.
4. Remove the water tank and rinse out.
5. Fill the water tank with fresh water, attach to the unit and release steam thru the system until the water tank is empty.

! CAUTION:

Do not leave the steamer unattended during the limescale removal process and/or while in use.

Note: After each limescale removal it is required to perform a test cleaning on a suitable isolated area to ensure that there is no debris left in the system.

• **Cleaning blocked steamer accessories.**

Due to the high mineral content of water in some areas, you may notice that less steam comes out from certain accessories. This may be caused by calcium buildup inside the tips of the nozzles.

How to clean Calcium buildup:

We recommend using the WD-40 lubricant. Spray a small burst or two of the lubricant inside the ends of each affected accessory. After spraying inside the component, fill your steamer with water according to the directions and run a continuous jet of steam through the affected accessory for several minutes to remove the deposit. Once the steam pathway is clear, aim the steamer at a neutral surface or a cleaning cloth to make sure there is no debris being emitted.

WE RECOMMEND DOING THIS PROCEDURE IN A PROTECTED AND VENTILATED AREA.



WARNING – DANGER OF SCALDING



AFTER USE

- 1) Unplug Power Cord (Part 18) from outlet.
- 2) Allow Mop Pad to cool down and carefully remove Mop Pad (Part 20) from Mop Head (Part 16), as Mop Pad could still be hot.
- 3) Any water remaining in the Water Tank (Part 9) should be emptied prior to appliance storage.
- 4) Let any water (remained as a product of condensation) drain from the steam nozzle prior to storing the appliance.
- 5) Wrap Power Cord around Cord Holder (Part 3).
- 6) Wipe all surfaces of the H2O Mop® Ultra™ Steamer with a soft cloth. Store in a protected, dry area.
- 7) Mop Pad can be machine washed in hot water. Disposable pads are designed for one time use.

! CAUTION:

Upright storage of the H2O Mop® Ultra™ Steamer with a wet Mop Pad may result in the formation of white marks on your floor. To remove the white marks, clean area with vinegar. Make sure to remove the Mop Pad before storage.

! IMPORTANT:

• Always empty the water tank at the end of each use, if any deposits remain in the tank, you can add some water, swirl it around, cover the cap, shake and empty it. Repeat as needed. **DO NOT IMMERSE IN WATER.**

CLEANING AND MAINTENANCE

⚠ WARNING: BE SURE THAT THE UNIT IS DISCONNECTED FROM THE POWER OUTLET WHEN PERFORMING THIS PROCEDURE .

• **How to decalcify the water tank interior:**

To clean calcium deposits that build up inside the water tank, add one or two tablespoons of white vinegar to a full water tank, close the water tank cap and shake the contents. **DO NOT TURN THE STEAMER ON.** Let it sit for a few hours. Then, empty the water tank and refill with clean water and empty until it rinses clear.

• **Cleaning procedure to remove limescale**

If your H2O Mop® Ultra™ begins to produce steam more slowly than usual or stops producing steam you may need to remove limescale. Limescale can develop over time on the metal parts and greatly affect the mop performance. We recommend removing limescale on a regular basis especially in areas with hard water.

The frequency of limescale removal depends upon the hardness of your tap water and how often you use the steam mop.

To remove limescale from the H2O Mop® Ultra™ please follow these procedures:

By using Scraper

1. Make sure that the H2O Mop® Ultra™ is disconnected from the power supply before maintenance.
2. Remove the hand-held steamer from the main body and the adaptor as described in How To Use The Hand-Hald Steamer section on page 8.
3. Use any suitable metal pin (i.e. long sewing needle) to remove scale deposits from the small hole of the steam outlet, as illustrated in Fig 1. By swirling and pushing the pin up and down you will clean the steam outlet. Always ensure that all scale debris has been removed from the steam outlet before reassembling. Continue swirling "pin" until no further debris is evident.
4. Attach the Hand-Hald Steamer to the main body.

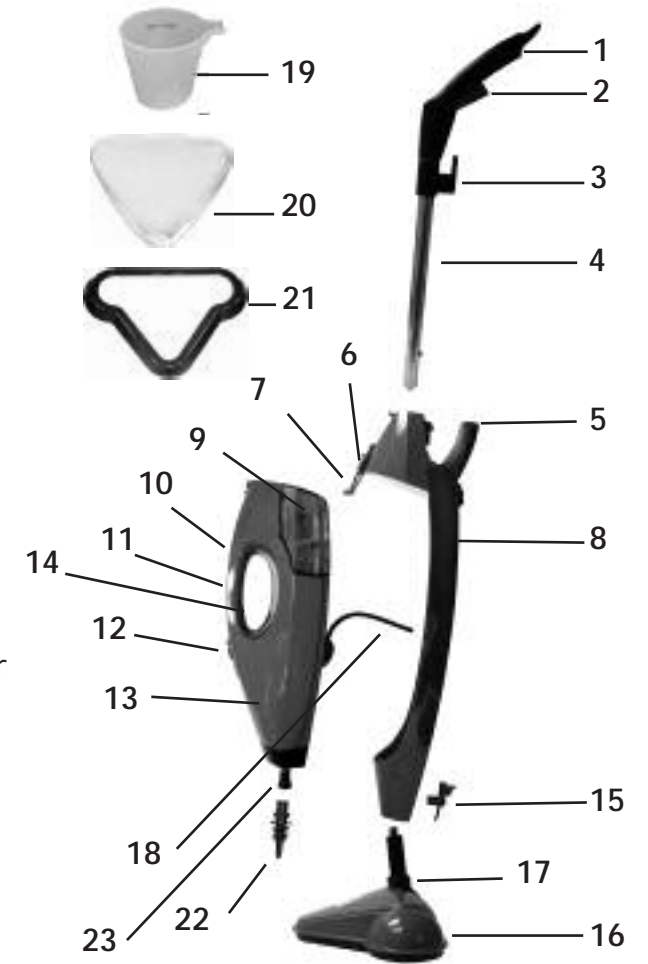

Fig.1



KEY FEATURES

1. Handle
2. ON/OFF Switch on handle
3. Cord Holder
4. Handle Tube
5. Carrying Handle
6. Hand-Held Steamer Release Button
7. Hand-Held Steamer Body Lock
8. H2O Mop® Ultra™ Body
9. Water Tank
10. Power Indicator
11. Ready-To-Use Indicator
12. ON/OFF Switch on Hand-Held Steamer
13. Hand-Held Steamer Body
14. Hand-Held Steamer Handle
15. Mop Head locking Clip/Accessory Tray Holder
16. Mop Head
17. Swivel Joint
18. Power Cord
19. Measurement Cup
20. Mop Pad
21. Carpet Glider
22. Short Jet Nozzle
23. Adapter



ACCESSORY TRAY (CADDY KIT) (OPTIONAL ITEMS)

1. Window Cleaning Kit
2. Fabric Tool
3. Cleaning Cloths
4. Round Brushes (2 nylon and 1 copper)
5. Triangle Brush (nylon)
6. Scoop Nozzle
7. Jet Nozzle
8. Extension Hose
9. Angle Nozzle

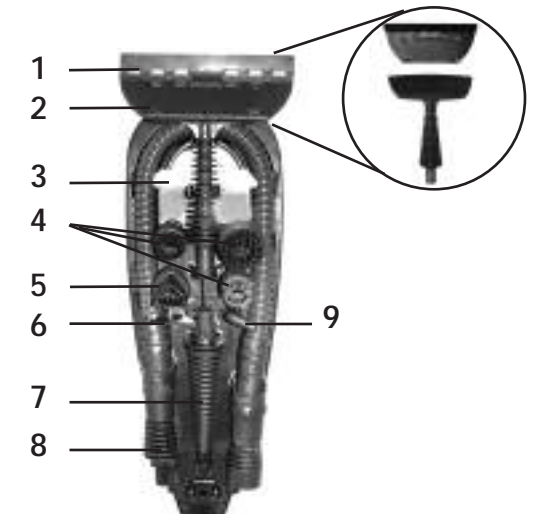



HOW TO ASSEMBLE THE H2O MOP® ULTRA™

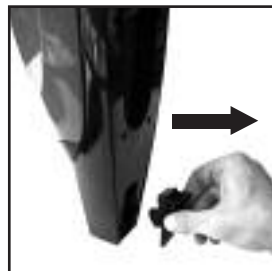

1) Remove Mop Head locking Clip (Part 15) located at the bottom of the H2O Mop® Ultra™ Body (Part 8) as illustrated.

2) Remove the Hand-Held Steamer from the H2O Mop® Ultra™ Body as follows:
 a) Unlock the Hand-Held Steamer Body (Part 13) by lifting up the Hand-Held Steamer Body Lock (Part 7)
 b) Push the Hand-Held Steamer Release button up (Part 6).
 c) Detach the Hand-Held Steamer Body out.



3) Attach Mop Head (Part 16) to the H2O Mop® Ultra™ Body (Part 8) by inserting the Swivel Joint (Part 17) into the designated hole in the H2O Mop® Ultra™ Body (Part 8) as illustrated.



4) Put back the Mop Head locking Clip (Part 15) to lock in the Mop Head.

5) Attach the Hand-Held Steamer to the H2O Mop® Ultra™ Body and lock in place using the Hand-Held Steamer Body Lock (Part 7).



6) Slide Handle Tube (Part 3) down into H2O Mop® Ultra™ Body (Part 8) until it clicks in.

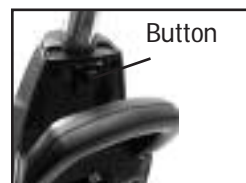

NOTE: To remove the Handle Tube (Part 3) Press the Button and pull up the Handle Tube as illustrated.



HOW TO USE THE ACCESSORIES (OPTIONAL ITEMS) CONTINUED

To use the Round Brushes (Part 4), Triangle Brush (Part 5), Scoop Nozzle (Part 6) and the Angle Nozzle (Part 9) attachments follow these instructions:

1. Attach the Extension Hose to the Hand-Held Steamer.
 2. Attach the Jet Nozzle to the Extension Hose.
- NOTE: You can attach the Jet Nozzle directly to the Hand-Held Steamer without using the Extension Hose but for better accessibility we recommend attaching the Jet nozzle to the Extension Hose.



3. Attach the desired attachment to the Jet Nozzle as follows:
 Align the two pins located at the tip of the nozzle with the matching channel marked with an Arrow mark on each attachment (Round Brushes, Triangle Brush, Scoop Nozzle and Angle Nozzle). Insert the tip of the Jet Nozzle into the attachment's opening, push and turn the attachment clockwise 90° to lock in place.

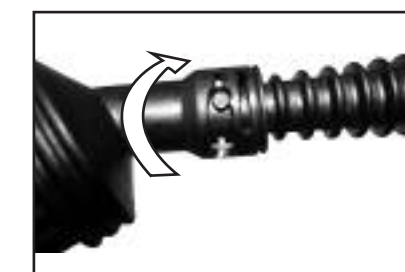
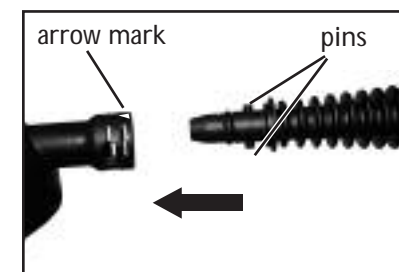

To remove the attachment, turn the attachment counterclockwise and detach from the Jet Nozzle.

To attach the Hand-Held Steamer back to the H2O Mop® Ultra™ Steamer Body:

Remove all attachments

- 1) Insert the Power Cord in the clip on the side of the Hand-Held Steamer Body.
- 2) Align and insert the adaptor on the Hand-Held Steamer with the nozzle at the H2O Mop® Ultra™ Body.
- 3) Push the Hand-Held Steamer against the H2O Mop® Ultra™ body until it clicks in place.
- 4) Lock the Hand-held Steamer by turning back the Hand-Held Steamer Body lock down.





HOW TO USE THE ACCESSORIES (OPTIONAL ITEMS)

To attach the Extension Hose (Part 8) and the Jet Nozzle (Part 7) follow these instructions:

a) Pull adapter (Part 23) out of channel

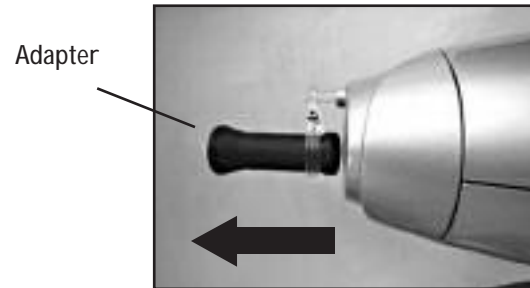

b) Turn adapter (Part 23) to ensure channel opening is accessible

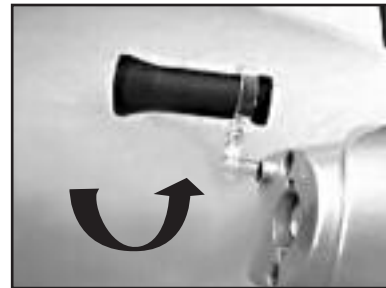

c) Align Jet Nozzle or the Extension Hose to line up with the corresponding slots inside the channel opening

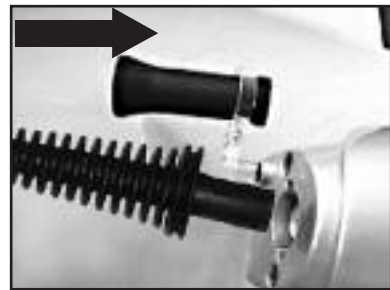

d) Push Jet Nozzle or the Extension Hose in the channel until it reaches the end, then turn clockwise to lock it in place

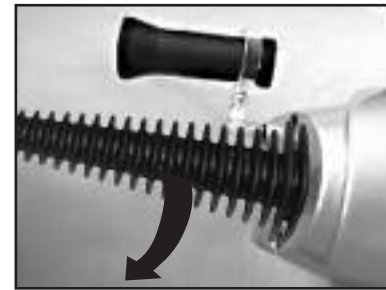

! NOTE:

To remove or replace attachments, rotate the attachment counter-clockwise and pull out.

The Jet Nozzle (Part 7) can be connected to the Hand-Held Steamer (Part 13) directly or through the Extension Hose (Part 8).

To use the Window Cleaning Kit (Part 1) attach the Window Cleaning Kit to the Extension Hose (or directly to the hand-held steamer)

To use the Fabric Tool, remove the Squeegee from the Window Cleaning Kit and attach the cleaning Cloth (Part 3)

NOTE: When working with the Window Cleaning Kit and the Fabric Tool we recommend using the Extension Hose for maximum accessibility.

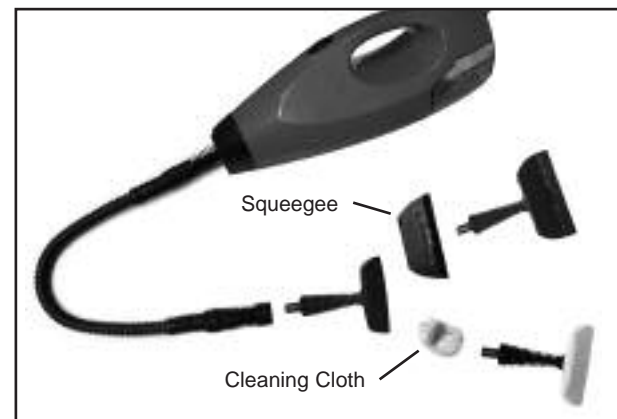

HOW TO USE THE H2O MOP® ULTRA™

1) Attach a Mop Pad such as (Microfiber Cloth or Disposable Pad (Optional Item) or Microfiber Ultra Cloth-Optional Item)

• If using the Microfiber Cloth (Part 20)

1. Attach the Microfiber Cloth, (Part 20) to the Mop Head (Part 16) as illustrated in Fig. 1.
2. Wrap the drawstring around the Mop Head and tighten it up as illustrated in Fig. 2.
3. When using the H2O Mop® Ultra™ on carpet surfaces; place the mop head (with microfiber pad in place) on top of the carpet glider (part 21) as illustrated in Fig. 3. Do not attempt to use the H2O Mop® Ultra™ on carpet/rug surfaces without the carpet glider in place. Never use the carpet glider on surfaces that are prone to scratching.

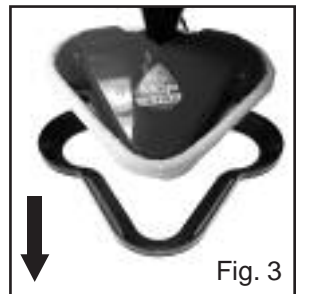
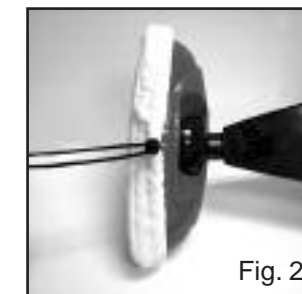
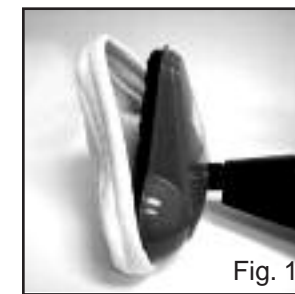

- Microfiber cloth care:
- Machine wash 60 °C (140 °F)
 - Do not bleach
 - Do not use softener

• If using the Disposable Pad (Optional Item)

1. Locate the label on the Disposable Pad as illustrated in Fig. 1.
2. Attach the Pad to the Mop Head, the label on the front of the pad should go on the front of the Mop Head as illustrated in Fig. 2.
3. Dispose the Pad after use, Fig. 3.

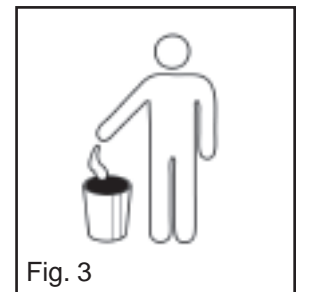
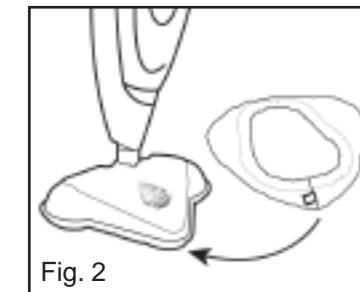
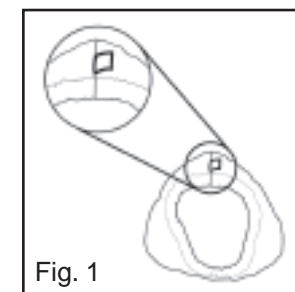

! NOTE:

The Disposable Pad fits tight to the mop head so it stays in place during use and it is designed for one time use only. Never use the disposable pad or microfiber pad if the cloth has any noticeable holes, abrasions or other forms of degradation. By using a damaged pad or cloth, streaking and possible scratching of the floor surface may occur.



• If using the Microfiber Ultra Cloth (Optional item)

Attach the Ultra Cloth to the Mop Head (Part 16) by, following the same instructions as provided above for the Microfiber Cloth. Microfiber Ultra Cloth is soft and durable with hundreds of super absorbing fringes, ideal for your sealed hardwood, ceramic and other types of flooring.

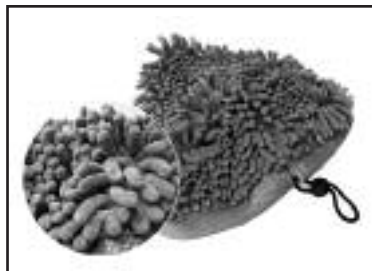

Ultra Cloth care:

- Machine wash 60 °C (140 °F)
- Do not bleach
- Do not use softener

! NOTE:

Do not operate the H2O Mop® Ultra™ without a Mop Pad such as either Microfiber Cloth or Disposable Pad and Microfiber Ultra Cloth in place.

2) Fill the Water Tank (Part 9)

NOTE: Make sure that the H2O Mop® Ultra™ is unplugged.

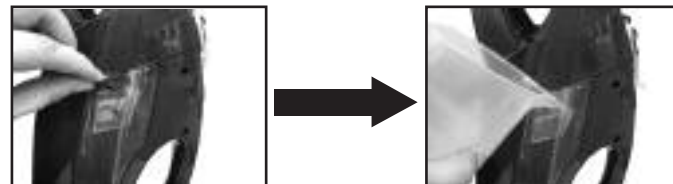

• Using the Measuring Cup:

- 1) Open the rubber plug.
- 2) Using the measuring cup (Part 19) fill the Water Tank (Part 9) until it reaches the MAX line indicated on the tank. Do not overfill.

• Directly from Tap

- 1) Release the Hand-Held Steamer Body Lock (Part 7) by lifting up
- 2) Push the Hand-Held Steamer Release button (Part 6) upward
- 3) Take Hand-held Steamer out by lifting upward and pulling backward.
- 4) Press the Water Tank Release button down and Pull Water Tank out.
- 5) Remove the rubber plug and fill the water tank directly from tap. Close the rubber plug and wipe off any water spills. Block the valve hole on the water tank with a finger so water doesn't drip from the water tank valve while filling under tap and moving back to the Hand Held Steamer body.
- 6) Put the water tank back and make sure that it is firmly positioned in its designated slot.

H2O Mop® Ultra™ uses tap water.

However, in areas with hard water, distilled water should be used for better performance.

! IMPORTANT:

Make sure the COPPER BALL inside the water tank is always submerged in water while operating the H2O Mop® Ultra™.

⚠ WARNING:

Never put cleaning detergents or scented products into the H2O Mop® Ultra™. This will make the operation unsafe and damage the unit.

PLEASE READ BEFORE USE

The H2O Mop® Ultra™ is designed to thoroughly clean floor surfaces, such as marble, ceramic, carpet, stone, linoleum, sealed hardwood floor and parquet. Not all floors types are suitable for steam cleaning. On surfaces that have been treated with wax, the wax may be removed by the heat and steam action. Do not use on unsealed flooring or let unit stand on any wood or heat sensitive floor for an extended period of time. This could cause the wood grain to rise. When using on vinyl, linoleum or any other heat sensitive floors, use extra caution. Too much heat can melt down glue in the flooring. When using the appliance on laminated floor, the laminated floor should have been laid professionally and not have any gaps or cracks in which humidity could enter. Test the H2O Mop® Ultra™ on a small isolated area of your flooring prior to overall use on any floor surface.



**HOW TO USE ACCESSORY TRAY
(OPTIONAL ITEMS)**

- 1) Insert the Accessory Tray tongue (located on the bottom of the Accessory Tray) in the designated slot on the back of the H2O Mop® Ultra™ Steamer Body.
- 2) Push the Accessory Tray against the H2O Mop® Ultra™ Steamer Body (Part 8) until it clicks in.



To remove the Accessory Tray:

- 1) Release the Accessory Tray Lock on the back, top part of the H2O Mop® Ultra™ Steamer Body (Part 8) by lifting up the button.
- 2) Pull the Accessory Tray back to detach .

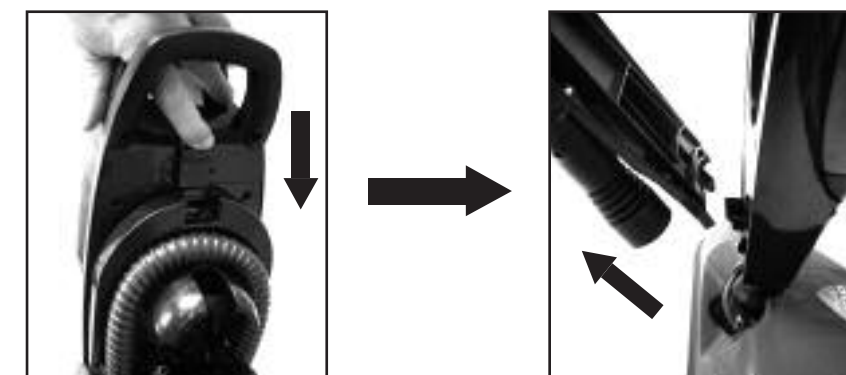



ACCESSORY TRAY (CADDY KIT) (OPTIONAL ITEMS)

1. Window Cleaning Kit
2. Fabric Tool
3. Cleaning Cloths
4. Round Brushes (2 nylon and 1 copper)
5. Triangle Brush (nylon)
6. Scoop Nozzle
7. Jet Nozzle
8. Extension Hose
9. Angle Nozzle

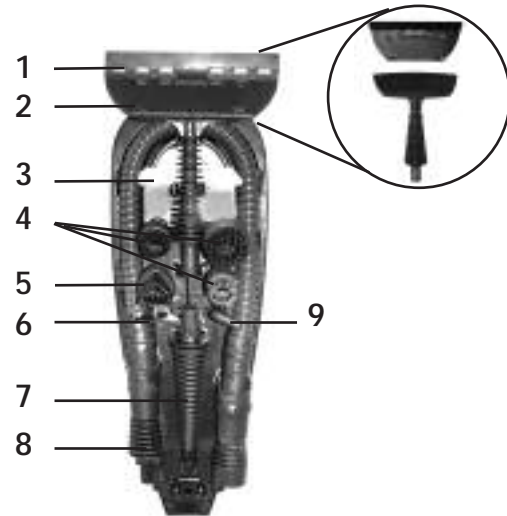

 Window Cleaning Kit with Squeegee (Part 1):
Perfect to clean windows, clean glass and hard surfaces

 Fabric Tool
(Part of Window Cleaning Kit, Part 2):
Remove Squeegee attachment and install the cleaning cloth, great for steaming out wrinkles and deodorizing fabrics. It is recommended that the Fabric Tool is attached to the Extension Hose for maximum accessibility for clothing, upholstery and window treatments

 Cleaning Cloths (Part 3):
To use with Fabric Tool

 Round Brushes (Part 4): and

 Triangle Brush (Part 5):
Recommended for sealed grout, cook tops and bench tops

 Scoop Nozzle (Part 6):
Ideal to clean hard surfaces

 Jet Nozzle (Part 7):
Handy for use in corners and edges

 Extension Hose (Part 8):
Perfect for hard-to-reach areas

 Angle Nozzle (Part 9):
Ideal for hard-to-reach areas such as windowsills and toilet bowls



Always check the use and care instructions of your flooring manufacturer before using the H2O Mop® Ultra™. If in any doubt, please consult a specialist. Only use the carpet glider on carpeting & rugs. Use of the carpet glider on other floor surfaces will cause streaking and can possibly scratch the surface.

NOTE: This product emits steam and it will create moisture. If left operating too long in one place it can create water marks or even cause discoloration or damage the floor surface.

3) How To operate The H2O MOP® ULTRA™

1) Place the power cord in the cord holder as illustrated in fig. 1 when operating the H2O Mop® Ultra™

2) Plug in the Power Cord to the grounded electrical outlet.

RED light - Power Indicator (Part 10) will indicate when power is on.

3) Wait for the Ready-to-use indicator (Part 11) to turn Green - approximately 30 seconds.

GREEN light will be on when the steam mop is ready for use. If the ON/OFF switch is pressed prior to ready light indicator turning green, water from previous use will not be heated and will be forced out by present steam and will cause puddling to occur.

This may also happen if the ON/OFF switch was left in ON position from previous use and the unit was disconnected by unplugging only.

Note: make sure to turn the unit OFF after each usage and then disconnect from an electrical outlet so the unit is in OFF position when used next time.

4) Press the ON/OFF switch (Part 2) to release steam. The mop will start emitting steam. To stop emitting steam turn OFF the unit by pressing the ON/OFF switch again.

5) Slowly pass over surface to be cleaned. The absorbent mop pad picks up the dirt loosened by the steam. Apply steam liberally. Keep a towel handy and wipe away any excess water that may accumulate.

6) When the Steam Mop stops emitting steam, simply turn off and unplug the Mop, refill the Water Tank and continue cleaning.

For Best Results:

1) Sweep or vacuum floor prior to using the Mop.

2) To avoid puddling of water - the Microfiber Cloth, Disposable Pad (Optional Item), or Ultra Cloth (Optional item) must be clean and dry for use. Apply new Microfiber Cloth or Disposable Pad or Ultra Cloth and continue use. (If using a Disposable Pad: Remember to let pad cool, then remove from unit, replace with new Disposable Pad and continue use. If using Microfiber Pad: Let pad cool, remove pad from unit, replace with new Microfiber Pad and continue use.

3) To sanitize an area of your floor, leave the H2O Mop® Ultra™ over area for a about 10 seconds, but no longer than 15 seconds. **WARNING:** Do not carry out this procedure on heat and steam sensitive floors.

! IMPORTANT:

- Never steam at one spot for too long. This can cause floor surface damage.
- During first use, it may take several seconds for the H2O Mop® Ultra™ to begin steaming. The water needs to flow through the filter to the heater. This delay will only occur during initial use.
- When filling with water for the first time, or refilling, a grinding noise may be heard indicating the pump is warming-up. This is normal and will stop when the H2O Mop® Ultra™ is ready.
- During continuous use of the H2O Mop® Ultra™ the green light will go on and off – this is normal. The green light indicates that the heater has reached its assigned temperature and when the green light goes off, during use, it means that the heater is heating up again. However this will not affect the mop performance and you may continue cleaning as usual.
- It is normal that there may be some minor “spitting” of water mixed with the steam.
- The force and heat of the steam may adversely affect certain materials. Always check the suitability of using the steam mop on a surface by carrying out a preliminary test on a hidden area.

Thane Direct and its subsidiaries assume no liability for damage caused by use of the H2O Mop® Ultra™ other than for its intended use or as instructed above and in the H2O Mop® Ultra™ User Guide or outside of the “Use and Care Instructions” of your flooring manufacturer.



Fig. 1

HAND-HELD STEAMER

The Hand-Held Steamer is an ideal portable cleaner. It is there for you to detach and use on work surfaces, kitchen countertops, sinks, bathrooms, windows, mirrors, tiles and spot cleaning on floor carpets and rugs. Use it with an attachment (Optional Items) to spray away dirt, grease, mold, remove wrinkles from curtains, soft furnishings, and more.

HOW TO USE HAND-HELD STEAMER

- 1) To release the Hand-Held Steamer.
 - a) Unlock the Hand-Held Steamer Body (Part 13) by lifting up the Hand-Held Steamer Body Lock (Part 7)
 - b) Push the Hand-Held Steamer Release button up (Part 6).
 - c) Detach the Hand-Held Steamer Body out.

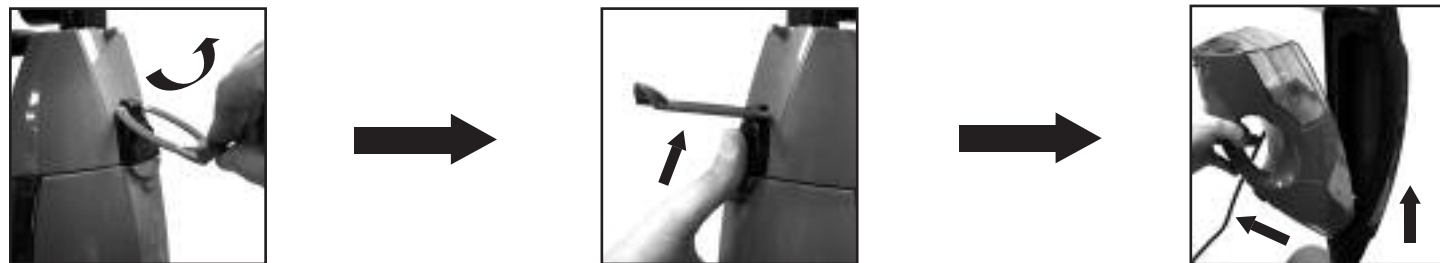

- 2) To install the Short Jet Nozzle Attachment (Part 22)::

- a) Ensure the Hand-Held Steamer (Part 13) has been detached from the H2O Mop® Ultra™ Body (Part 8)
- b) Pull adapter (Part 23) out of channel

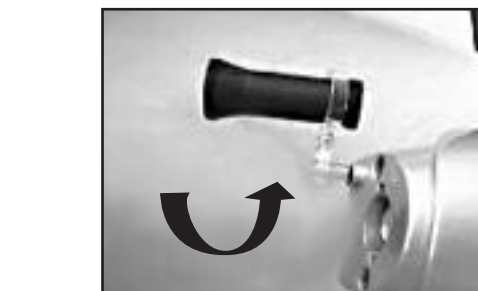
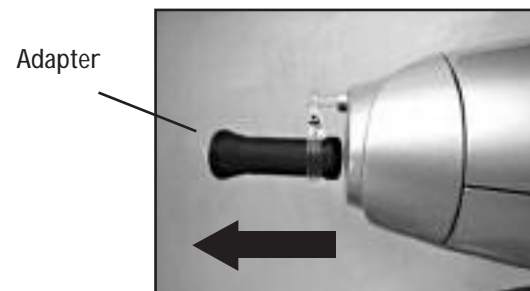

- c) Turn adapter (Part 23) to ensure channel opening is accessible
- d) Align Short Jet Nozzle attachment to line up with the corresponding slots inside the channel opening



- e) Push Short Jet Nozzle attachment in the channel until it reaches the end, then turn clock-wise to lock it in place

! NOTE:

To remove or replace attachments, rotate the attachment counter-clockwise and pull out.

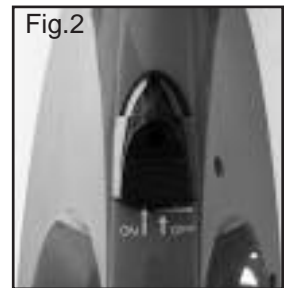
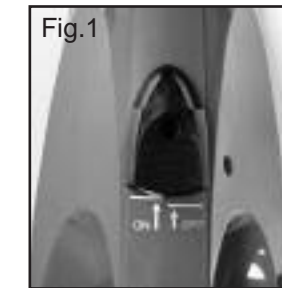

- 3) Make sure that the water tank is full, refill if required. refer to page 6, (2) Fill the Water Tank.
- 4) Plug in the Power Cord to the grounded electrical outlet. RED light - Power Indicator (Part 10) will indicate when power is on.
- 5) Wait for the Ready-to-use indicator (Part 11) to turn Green - approximately 30 seconds. GREEN light will be on when the steam mop is ready for use. If the ON/OFF switch is pressed prior to ready light indicator turning green, water from previous use will not be heated and will be forced out by present steam and will cause puddling to occur. This may also happen if the ON/OFF switch was left in ON position from previous use and the unit was disconnected by unplugging only.
Note: make sure to turn the unit OFF after each usage and then disconnect from an electrical outlet so the unit is in OFF position when used next time.
- 6) When the Ready-To-Use indicator light turns green push the ON/OFF switch (Part 12) once to ON position as illustrated in Fig 1.

The hand-held steamer will emit steam continuously. To stop emitting steam, press the ON/OFF switch (Part 12) again and the switch button will come to OFF position as illustrated in Fig 2.

The hand-held steamer will stop emitting steam.

NOTE: During continuous use of the H2O Mop® Ultra™ the green light will go on and off – this is normal. The green light indicates that the heater has reached its assigned temperature and when the green light goes off, during use, it means that the heater is heating up again. However this will not affect the performance and you may continue cleaning as usual.

It is normal that there may be some minor “spitting” of water mixed with the steam.

! NOTE:

To sanitize your work surfaces, kitchen kitchen countertops, sinks, bathrooms, etc. Use the Hand-Held Steamer over an area for about 15 seconds.

WARNING: Do not carry out this procedure on heat and steam sensitive surfaces.

The force and heat of the steam may adversely affect certain materials. Always check the suitability of using the steamer on a surface by carrying out a preliminary test on a hidden area.

⚠ WARNING:

- Never direct steam towards people, animals and plants.
- Do not use the steam to clean frozen windows.
- Be careful when using the steamer on glass, as it may break.
- Do not use steamer on leather, wax polished furniture or waxed floors, synthetic fabrics, velvet or other delicate steam-sensitive materials.

Thane Direct and its subsidiaries assume no liability for damage caused by use of the H2O Mop® Ultra™ other than for its intended use or as instructed above and in the H2O Mop® Ultra™ User Guide or outside of the “Use and Care Instructions” of the treated surface manufacturer.